



The Optimum in Yacht Cruising



The good life



Sleek yachts



Classy interiors



Built in Italy by C.T.M., Monte Carlo is a unique combination of speed and beauty. From her sleek external lines, to dual MTU engines that provide a 27 knots top speed, this Falcon 100 class motoryacht is a byword for stylistic and technical excellence. Whether on the Main aft Deck or on the bimini shaded Sun Deck, there is plenty of space aboard Monte Carlo for sun bathing, relaxing, enjoying a breakfast or lunch served by the professional hostess and prepared by a highly experienced Chef.

motoryacht monte carlo

THE CABINS

On the Main Deck, the VIP Cabin's features include a queen size bed, a spacious wardrobe, audio and video systems, a leather settee, a cozy armchair, a writing desk and en-suite bathroom with a Jacuzzi tub. The full width Master Cabin features a queen size bed, a walk in wardrobe, audio and video systems, a leather settee, a writing desk and en-suite bathroom. Monte Carlo also offers one Double plus two Twin Cabins, all with en suite bathroom, audio system and fully air conditioned.

DINING ROOM - MAIN LOUNGE

The elegance and classic Italian interior design, the oval dining table which extends to seat ten in comfort, gourmet cuisine from the fully equipped galley and attentive service from the crew combine to create the perfect atmosphere for formal meals. Like all of the Monte Carlo interior, the dining area is fully air conditioned. With the luxurious comfort of its leather upholstery, polished cherry wood paneling plus audio and video entertainment systems, the spacious salon on the Main Deck offers the ultimate in shipboard relaxation.

TOYS & WATERSPORTS

The large swimming platform is easily accessed to enjoy a full range of toys and water sports.



GENERAL INFORMATION



Builder	Falcon - C.T.M. Italy
Length	30.7 mt. / 100 ft.
Beam	6.45 mt.
Draft	2.33 mt.
Hull	GRP
Superstructure	GRP
Gross Tons	114 tons
MCA Status	Commercial Registry
Crew	6
Engines	2 x MTU 1800
Range	300 Naut. Miles
Cruising Speed	25 knots
Top Speed	27 knots
Fuel Capacity	11.000 Lt.
Water Capacity	5.000 Lt.
Watermaker	Technicomar
Communications	GSM G3 + WiFi VHF + SSB

CABINS & EQUIPMENT

10 Guests in 5 staterooms. Air conditioned throughout with individual climate control in each stateroom.

1 X MASTER	Lower Deck, en-suite bathroom, king size bed, vanity, walk in closet, satellite TV, DVD
1 X VIP	Main Deck, en-suite bathroom, queen size bed, vanity, satellite TV, DVD
2 X TWIN	Lower Deck, en-suite bathroom, satellite TV, DVD
1 X DOUBLE	Lower Deck, en-suite bathroom, satellite TV, DVD

1 x tender with 90 HP

2 stroke outboard

Various inflatables, one jet ski, waterskis, wakeboard, snorkeling equipment.



motoryacht

absolute king

In the world of motor yachting the Falcon 100 is deservedly a byword for stylish and technical excellence. With her streamlined profile and dual MTU engines delivering a 27-knot top speed and boasting sumptuous internal fittings, the ABSOLUTE KING represents a unique blend of power and luxury.

Experience the thrill of taking the helm on the flybridge with its state-of-the-art operation and navigation equipment, or just relax in the comfort of the ABSOLUTE KING'S Bimini – shaded sun deck and enjoy the beauty of the crystal waters and forested islands of maritime Greece.

THE CABINS

The full width Master Stateroom features a queen size bed, a walk-in wardrobe, an en-suite bathroom, full air conditioning and audio/video entertainment center. Also on the Main Deck, the VIP Cabin's features include a queen size bed, a large wardrobe, an en-suite bathroom, a writing desk, full air conditioning and integral audio/video systems. Further than the VIP and Master cabins, the ABSOLUTE KING also offers one Double and two twin cabins, all with ensuite bathrooms, full air conditioning and hi-fi audio systems.

DINING ROOM – MAIN LOUNGE

With its gleaming exotic wood paneling, the opulent comfort of its leather upholstery and built-in hi-fi comfort and video entertainment, the spacious salon on the Main Deck offers the ultimate in shipboard relaxation. As throughout the ABSOLUTE KING'S interior the salon is full air-conditioned.

TOYS & WATERSPORTS

The large swimming platform is easily accessed to enjoy a full range of toys and water sports.



GENERAL INFORMATION

Builder	Falcon - C.T.M. Italy
Length	30.7 mt. / 100 ft.
Beam	6.45 mt.
Draft	2.33 mt.
Hull	GRP
Superstructure	GRP
Gross Tons	114 tons
MCA Status	Commercial Registry
Crew	7
Engines	2 x MTU 1800
Range	300 Naut. Miles
Cruising Speed	25 knots
Top Speed	27 knots
Fuel Capacity	11.000 Lt.
Water Capacity	5.000 Lt.
Watermaker	Technicomar
Communications	GSM G3 + WiFi VHF + SSB

CABINS & EQUIPMENT

10 Guests in 5 staterooms. Air conditioned throughout with individual climate control in each stateroom.

1 X MASTER	Lower Deck, en-suite bathroom, king size bed, vanity, walk in closet, satellite TV, DVD
2 X VIP	Lower & Main Deck, en-suite bathroom, queen size bed, vanity, satellite TV, DVD
1 X DOUBLE	Lower Deck, en-suite bathroom, satellite TV, DVD
1 X TWIN	Lower Deck, ensuite bathroom, satellite TV, DVD.

1 x tender with 90 HP
 2 stroke outboard
 Various inflatables, one jet ski, waterskis, wakeboard, snorkeling equipment.



Both elegant and seaworthy, built with comfort in mind, she boasts a beautiful interior and accommodation, with superb deck spaces, the ideal yacht for an unforgettable experience. Whether you prefer to cruise at full speed, lie at anchor in a secluded bay, or just relax and enjoy the first class service offered by her professional crew, OBSESSION offers easy outdoor living with unique alfresco dining on both the upper sun deck and the main aft deck.

motoryacht

obsession

THE CABINS

Aboard OBSESSION, guests are pampered in comfortable staterooms (each with its own satellite TV, DVD and elegant en-suite facilities). The Master stateroom and en-suite bathroom situated on the Lower Deck, is full beam and boast a king-size bed, along with a complete entertainment center, including a large flatscreen equipped for individual satellite reception. The VIP staterooms and en-suite bathrooms situated on the Lower and Main Decks, are full beam and boast a queen-size bed, along with a complete entertainment center, including a large flatscreen equipped for individual satellite reception.

DINING ROOM – MAIN LOUNGE

The spacious main salon (fully air conditioned, as is the entire interior) is equipped with state of the art entertainment center, where you can enjoy the peace and the tranquility of the beautiful coastal surroundings. The dining room, the covered aft deck, or the comfortable Sun Deck invite you to relax while the highly trained Chef will surprise you with a variety of exquisite dishes.

TOYS & WATERSPORTS

The large swimming platform is easily accessible to enjoy a full range of toys and water sports.



GENERAL INFORMATION

Builder	Falcon - C.T.M. Italy
Length	30.8 mt. / 100 ft.
Beam	6.50 mt.
Draft	2.33 mt.
Hull	GRP
Superstructure	GRP
Gross Tons	114 tons
MCA Status	Commercial Registry
Crew	7
Engines	2 x MTU 1800
Range	300 Naut. Miles
Cruising Speed	25 knots
Top Speed	27 knots
Stabilizers	Koopnautic
Fuel Capacity	11.000 Lt.
Water Capacity	5.000 Lt.
Watermaker	Technicomar
Communications	GSM G3 + WiFi VHF + SSB

CABINS & EQUIPMENT

10 Guests in 5 staterooms. Air conditioned throughout with individual climate control in each stateroom.

1 X MASTER	Lower Deck, en-suite bathroom, king size bed, vanity, walk in closet, satellite TV, DVD
2 X VIP	Lower & Main Deck, en-suite bathroom, queen size bed, vanity, satellite TV, DVD
2 X DOUBLE	Lower Deck, en-suite bathroom, satellite TV, DVD

1 x tender with 90 HP
2 stroke outboard

Various inflatables, one jet ski, waterskis, wakeboard, snorkeling equipment.

desk plans

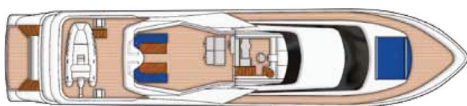

Sun deck

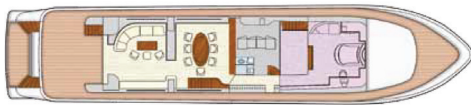

Main deck



Lower deck

Variety Cruises (17 to 36 cabins)



VOYAGER



HARMONYV



HARMONY G



PEGASUS



HARMONYV



PANORAMA



PANORAMA II



GALILEO

A brand of



Variety Cruises

The Yacht Cruise Experience